

WSSDA / WASA / WASBO

Legislative Conference and DAY ON THE HILL

February 12-13, 2017



WSSDA

wasa WASBO



“Stay present and stay engaged. Our policymakers in Olympia rely on each of us in our different roles to support them to do the right thing for our state’s 1.1 million public school scholars.”

- Geoffery McAnallo,
Federal Way School District
Board President, WSSDA
Legislative Committee Chair



Table of Contents

<u>Welcome</u>	4
<u>General Conference Information</u>	5
<u>Sunday, February 12</u>	6
<u>Sunday Association Meetings</u>	9
<u>Monday, February 13</u>	11
<u>Monday Association Meetings</u>	11
<u>Regional Caucuses</u>	12
<u>Legislative Committee Members</u>	18
<u>Transportation and Parking</u>	20
<u>Hotel RL (Red Lion) Map</u>	21
<u>SPSCC Campus Map</u>	22
<u>SPSCC Building Maps</u>	24
<u>Capitol Campus Map</u>	26
<u>2017 Upcoming Events</u>	Back Cover

SAVE THE DATE

January 28–29, 2018

WASA / WSSDA / WASBO

Legislative Conference and Day on the Hill

South Puget Sound Community College and Capitol Campus



2017 Legislative Conference

Welcome

Welcome to the 2017 Legislative Conference and Day on the Hill!

There has never been a more important time to come together with a unified voice on behalf of our public schools and 1.1 million public school students. The state's paramount duty is clear: to amply fund basic education for every one of our students in the state. The Washington Supreme Court has reaffirmed that constitutional mandate and the Legislature is on the hook to find the funding by the end of this legislative session.

You and your colleagues have been engaged since day one of the 2017 session, as there is so much for us to be attentive to this year. This conference provides us with an opportunity to receive updates on the education funding and policy landscape. We have designed the conference program to provide insights and the most current updates on the issues that you will visit with legislators about tomorrow. Following the afternoon presentations, regional caucus meetings will give you time to get organized for Monday meetings, and the Legislative Reception Sunday evening provides us with a chance to network with colleagues and legislators.

Each of you has an essential role in the legislative dialogue. As elected school directors, school administrators, and school business officials, you have your hands on the pulse of the community and are the experts on education issues. It is so very important that we capitalize on this tremendous opportunity to advocate with one voice for basic education to ensure all of our students have the opportunity to learn, and 21st Century facilities in which to learn.

Your presence and participation is essential. Thank you for prioritizing your time to join us – and for serving the students of Washington State.



Joanne Greer
School Director
Deer Park School District
President, WSSDA



Lois Davies, Ed.D.
Superintendent
Pateros School District
President, WASA



Doug Matson, CSBA
Deputy Superintendent
West Valley (Spokane)
School District
President, WASBO

General Conference Information

Association Meetings

Meeting locations for Sunday are listed on page 9, and Monday's meetings are listed on page 11.

Check-In

Conference registration opens at 11:30 a.m. Sunday in the Minnaert Center Lobby. Seating opens at noon.

Name Badges

Please wear your conference name badge for all conference functions.

Transportation and Parking

See page 20 for all transportation information for Sunday's Conference and Monday's Day on the Hill (Red Lion Hotel shuttle, Dash buses and Capitol Campus parking).

Clock Hours

Five clock hours for Sunday's conference are available at the registration table.

"This session is the Legislature's last opportunity to make good on its obligation to the court to amply fund basic education. They need us, and we need them!"

- Mike Brophy
West Valley (Yakima) School
District Superintendent, WASA
Finance Committee Chair

Sunday Schedule

Sunday, February 12

SOUTH PUGET SOUND COMMUNITY COLLEGE

Minnaert Center for the Arts and nearby campus buildings

7:30 a.m. – 12:30 p.m.

Association Meetings

See page 9 for meeting locations and times

Legislative Conference – Welcome all!

Minnaert Center for the Arts, Building 21

11:30 a.m.

Registration opens

Lobby

Theater seating opens at noon

1:00 – 5:00 p.m.

General Session

Auditorium Theater

1:00 – 1:15 p.m.

Welcome and Introductions

1:15 – 1:45 p.m.

State of the State of Education: OSPI Priorities and More

- Chris Reykdal, Superintendent of Public Instruction
(Introduction by Lois Davies, President, WASA)

1:45 – 2:15 p.m.

McCleary v. State of Washington: Where do we stand?

- Michael Dunn, Ed.D., 2017 NEWS President, North East Washington ESD 101 Superintendent
- Thomas Ahearn, Attorney at Law, Foster Pepper PLLC; Lead Counsel, NEWS
(Introduction by Doug Matson, President, WASBO)

2:15 – 2:30 p.m.

Navigating Policy Issues with the 2017 Legislature

Panel Discussion: Take Action and Tell Your Story

Moderator: Linda Shaw, *Seattle Times* Education Editor

Panelists:

- Stephen Nielsen, Deputy Superintendent, Seattle Public Schools
- Corine Pennington, Chief Financial Officer, Puyallup School District
- Cory Plager, Director, School Financial Services, North East Washington ESD 101

2:30 – 3:15 p.m.

Break

Black Box

3:15 – 4:00 p.m.

Continued: Navigating Policy Issues with the 2017 Legislature

4:00 – 4:30 p.m.

WSSDA / WASA / WASBO Hot Topics Briefing:

- Jessica Vavrus, Director of Governmental Relations, WSSDA
- Dan Steele, Assistant Executive Director, Government Relations, WASA; Legislative Consultant, WASBO

4:30 – 4:45 p.m.

Governor Inslee's Education Priorities

- Governor Jay Inslee
(Introduction by Joanne Greer, President, WSSDA)

4:45 – 5:00 p.m.

Get Ready for the Day on the Hill

- Jessica Vavrus and Dan Steele

5:15 – 6:15 p.m.

Regional Caucus Meetings

Join district leaders from your region to coordinate legislator meeting attendance and align messages for Monday's Day on the Hill.

- Detailed information and locations are on pages 12 – 17

6:15 – 8:00 p.m.

Legislative Reception

Please join your colleagues and invited legislative guests to continue the conversation over beverages and hors d'oeuvres. Student attendees will gather in a designated area in the Student Union Building, Building 27

**Thank you to our sponsors
for making this reception available
and for their work in
supporting public education!**

Hors d'oeuvres sponsored by



PiperJaffray

Beverages and student gathering sponsored by

BLRB architects



HILL

Hill International



Sunday Association Meetings

7:30 – 9:30 a.m.

WIAA Superintendent Advisory Committee
Building 23, Room 202

8:00 – 9:50 a.m.

WSSDA Legislative Committee
Building 21, Room 285

8:00 – 10:00 a.m.

WASA Legislation and Finance Committee
Building 23, Room 203

10:00 – 10:50 a.m.

WSSDA Equity and Access Caucus
Building 21, Room 130

10:00 a.m. – 12:00 p.m.

WASBO Legislative Affairs Committee
Building 23, Room 219

10:00 a.m. – 12:30 p.m.

WASA Board
Building 23, Room 220

11:00 a.m. – 12:15 p.m.

WSSDA Large Schools Caucus
Building 21, Room 130

11:00 a.m. – 12:15 p.m.

WSSDA Small Schools Task Force
Building 21, Room 287



Monday Schedule

Monday, February 13

DAY ON THE HILL

Capitol Campus

7:00 a.m. – 4:00 p.m.

Meetings with Legislators

As scheduled, starting at 7:00 a.m.

Since Legislative meetings begin bright and early Monday morning, we will maintain a home base for members in the Pritchard Building Cafeteria throughout the day starting at 7:00 a.m. Look for us at tables in the far right corner of the cafeteria with our Legislative Conference placard.

Copies of Legislator Appointments and extra Hot Topics handouts will be available. If last-minute changes are made, they will be recorded on a master schedule that you can access at the home base in Pritchard.

- **Note:** This year we were unable to secure a separate meeting room for members as we have had in past years. Staff will be available throughout the day at the home base tables in Pritchard; and there are many other places throughout campus to rest and replenish your energy (such as the Dome Deli in the basement of the Legislative Building; and Capitol Rotunda steps).

Monday Association Meetings

Hotel RL

7:30 – 8:30 a.m.

WSSDA Trust Lands Task Force

Hemlock

Sunday Regional Caucus Schedule

About the Caucus

Get organized for the Day on the Hill! The regional caucuses are an important part of the conference to assure school district teams are organized for Monday's legislator meetings.

Members of WSSDA's Legislative Committee have scheduled meetings with each of the state's 147 legislators.

It is critical that teams of school directors, superintendents, and business officials participate in each meeting so that our policy makers have a full perspective of your shared education priorities.

Caucuses will focus on signing up for legislator appointments on Monday and aligning messages and talking points based on the WSSDA, WASA, and WASBO "Hot Topics."

Join your district and join your colleagues in the room below:

5:15 – 6:15 p.m.

ABERDEEN

Building 23, Room 220

ADNA

Building 23, Room 220

ALMIRA

Building 23, Room 203

ANACORTES

Building 26, Room 101

ARLINGTON

Building 26, Room 101

ASOTIN-ANATONE

Building 23, Room 203

AUBURN

Building 26, Room 102

BAINBRIDGE ISLAND

Building 26, Room 102

BATTLE GROUND

Building 21, Room 286

BELLEVUE

Building 26, Room 102

BELLINGHAM

Building 26, Room 101

BENGE

Building 23, Room 203

BETHEL

Building 23, Room 219

BICKLETON

Building 21, Room 285

BLAINE

Building 26, Room 101

BOISFORT

Building 23, Room 220

BREMERTON

Building 21, Room 130

BREWSTER

Building 23, Room 202

BRIDGEPORT

Building 23, Room 202

BRINNON

Building 21, Room 130

BURLINGTON-EDISON

Building 26, Room 101

CAMAS

Building 21, Room 286

CAPE FLATTERY

Building 21, Room 130

CARBONADO

Building 23, Room 219

CASCADE

Building 23, Room 202

CASHMERE

Building 23, Room 202

CASTLE ROCK

Building 21, Room 286

CENTERVILLE

Building 21, Room 286

CENTRAL KITSAP

Building 21, Room 130

CENTRAL VALLEY

Building 21, Room 287

CENTRALIA

Building 23, Room 220

CHEHALIS

Building 23, Room 220

CHENEY
Building 23, Room 203

CHEWELAH
Building 21, Room 287

CHIMACUM
Building 21, Room 130

CLARKSTON
Building 23, Room 203

CLE ELUM-ROSLYN
Building 21, Room 285

CLOVER PARK
Building 23, Room 219

COLFAX
Building 23, Room 203

COLLEGE PLACE
Building 21, Room 106

COLTON
Building 23, Room 203

COLUMBIA (STEVENS)
Building 21, Room 287

COLUMBIA (WALLA WALLA)
Building 21, Room 106

COLVILLE
Building 21, Room 287

CONCRETE
Building 26, Room 101

CONWAY
Building 26, Room 101

COSMOPOLIS
Building 23, Room 220

COULEE-HARTLINE
Building 23, Room 202

COUPEVILLE
Building 26, Room 101

CRESCENT
Building 21, Room 130

CRESTON
Building 23, Room 203

CURLEW
Building 21, Room 287

CUSICK
Building 21, Room 287

DAMMAN
Building 21, Room 285

DARRINGTON
Building 26, Room 101

DAVENPORT
Building 23, Room 203

DAYTON
Building 21, Room 106

DEER PARK
Building 21, Room 287

DIERINGER
Building 23, Room 219

DIXIE
Building 21, Room 106

EAST VALLEY (SPOKANE)
Building 21, Room 287

EAST VALLEY (YAKIMA)
Building 21, Room 285

EASTMONT
Building 23, Room 202

EASTON
Building 21, Room 285

EATONVILLE
Building 23, Room 219

EDMONDS
Building 26, Room 101

ELLENSBURG
Building 21, Room 285

ELMA
Building 23, Room 220

ENDICOTT
Building 23, Room 203

ENTIAT
Building 23, Room 202

ENUMCLAW
Building 26, Room 102

EPHRATA
Building 23, Room 202

EVALINE
Building 23, Room 220

EVERETT
Building 26, Room 101

EVERGREEN (CLARK)
Building 21, Room 286

EVERGREEN (STEVENS)
Building 21, Room 287

FEDERAL WAY
Building 26, Room 102

FERNDALE
Building 26, Room 101

FIFE
Building 23, Room 219

FINLEY
Building 21, Room 106

FRANKLIN PIERCE
Building 23, Room 219

FREEMAN
Building 23, Room 203

(continued next page...)

Sunday Regional Caucus Schedule

GARFIELD

Building 23, Room 203

GLENWOOD

Building 21, Room 286

GOLDENDALE

Building 21, Room 285

GRAND COULEE

Building 23, Room 202

GRANDVIEW

Building 21, Room 285

GRANGER

Building 21, Room 285

GRANITE FALLS

Building 26, Room 101

GRAPEVIEW

Building 23, Room 220

GREAT NORTHERN

Building 23, Room 203

GREEN MOUNTAIN

Building 21, Room 286

GRIFFIN

Building 23, Room 220

HARRINGTON

Building 23, Room 203

HIGHLAND

Building 21, Room 285

HIGHLINE

Building 26, Room 102

HOCKINSON

Building 21, Room 286

HOOD CANAL

Building 23, Room 220

HOQUIAM

Building 23, Room 220

INCHELIUM

Building 21, Room 287

INDEX

Building 26, Room 101

ISSAQUAH

Building 26, Room 102

KAHLOTUS

Building 21, Room 106

KALAMA

Building 21, Room 286

KELLER

Building 21, Room 287

KELSO

Building 21, Room 286

KENNEWICK

Building 21, Room 106

KENT

Building 26, Room 102

KETTLE FALLS

Building 21, Room 287

KIONA-BENTON

Building 21, Room 106

KITTITAS

Building 21, Room 285

KLICKITAT

Building 21, Room 286

LA CENTER

Building 21, Room 286

LA CONNER

Building 26, Room 101

LACROSSE

Building 23, Room 203

LAKE CHELAN

Building 23, Room 202

LAKE QUINAULT

Building 23, Room 220

LAKE STEVENS

Building 26, Room 101

LAKE WASHINGTON

Building 26, Room 102

LAKEWOOD

Building 26, Room 101

LAMONT

Building 23, Room 203

LIBERTY

Building 23, Room 203

LIND

Building 23, Room 203

LONGVIEW

Building 21, Room 286

LOON LAKE

Building 21, Room 287

LOPEZ ISLAND

Building 26, Room 101

LYLE

Building 21, Room 286

LYNDEN

Building 26, Room 101

MABTON

Building 21, Room 285

MANSFIELD

Building 23, Room 202

MANSON

Building 23, Room 202

MARY M KNIGHT

Building 23, Room 220

MARY WALKER

Building 21, Room 287

MARYSVILLE

Building 26, Room 101

McCLEARY

Building 23, Room 220

MEAD

Building 21, Room 287

MEDICAL LAKE

Building 23, Room 203

MERCER ISLAND

Building 26, Room 102

MERIDIAN

Building 26, Room 101

METHOW VALLEY

Building 23, Room 202

MILL A

Building 21, Room 286

MONROE

Building 26, Room 101

MONTESANO

Building 23, Room 220

MORTON

Building 23, Room 220

MOSES LAKE

Building 23, Room 202

MOSSYROCK

Building 23, Room 220

MOUNT ADAMS

Building 21, Room 285

MOUNT BAKER

Building 26, Room 101

MOUNT PLEASANT

Building 21, Room 286

MOUNT VERNON

Building 26, Room 101

MUKILTEO

Building 26, Room 101

NACHES VALLEY

Building 21, Room 285

NAPAVINE

Building 23, Room 220

NASELLE-GRAYS

River Building 21, Room 286

NESPELEM

Building 23, Room 202

NEWPORT

Building 21, Room 287

NINE MILE FALLS

Building 21, Room 287

NOOKSACK VALLEY

Building 26, Room 101

NORTH BEACH

Building 23, Room 220

NORTH FRANKLIN

Building 21, Room 106

NORTH KITSAP

Building 21, Room 130

NORTH MASON

Building 21, Room 130

NORTH RIVER

Building 23, Room 220

NORTH THURSTON

Building 23, Room 220

NORTHPORT

Building 21, Room 287

NORTHSHORE

Building 26, Room 102

OAK HARBOR

Building 26, Room 101

OAKESDALE

Building 23, Room 203

OAKVILLE

Building 23, Room 220

OCEAN BEACH

Building 21, Room 286

OCOSTA

Building 23, Room 220

ODESSA

Building 23, Room 203

OKANOGON

Building 23, Room 202

OLYMPIA

Building 23, Room 220

OMAK

Building 23, Room 202

ONALASKA

Building 23, Room 220

ONION CREEK

Building 21, Room 287

ORCAS ISLAND

Building 26, Room 101

ORCHARD PRAIRIE

Building 21, Room 287

ORIENT

Building 21, Room 287

ORONDO

Building 23, Room 202

OROVILLE

Building 23, Room 202

ORTING

Building 23, Room 219

OTHELLO

Building 21, Room 106

PALISADES

Building 23, Room 202

PALOUSE

Building 23, Room 203

PASCO

Building 21, Room 106

PATEROS

Building 23, Room 202

PATERSON

Building 21, Room 106

PE ELL

Building 23, Room 220

PENINSULA

Building 23, Room 219

PIONEER

Building 23, Room 220

(continued next page...)

Sunday Regional Caucus Schedule

POMEROY

Building 21, Room 106

PORT ANGELES

Building 21, Room 130

PORT TOWNSEND

Building 21, Room 130

PRESCOTT

Building 21, Room 106

PROSSER

Building 21, Room 106

PULLMAN

Building 23, Room 203

PUYALLUP

Building 23, Room 219

QUEETS-CLEARWATER

Building 21, Room 130

QUILCENE

Building 21, Room 130

QUILLAYUTE

Building 21, Room 130

QUINCY

Building 23, Room 202

RAINIER

Building 23, Room 220

RAYMOND

Building 23, Room 220

REARDAN-EDWALL

Building 23, Room 203

RENTON

Building 26, Room 102

REPUBLIC

Building 21, Room 287

RICHLAND

Building 21, Room 106

RIDGEFIELD

Building 21, Room 286

RITZVILLE

Building 23, Room 203

RIVERSIDE

Building 21, Room 287

RIVERVIEW

Building 26, Room 102

ROCHESTER

Building 23, Room 220

ROOSEVELT

Building 21, Room 286

ROSALIA

Building 23, Room 203

ROYAL

Building 21, Room 285

SAN JUAN ISLAND

Building 26, Room 101

SATSOP

Building 23, Room 220

SEATTLE

Building 26, Room 102

SEDRO-WOOLLEY

Building 26, Room 101

SELAH

Building 21, Room 285

SELKIRK

Building 21, Room 287

SEQUIM

Building 21, Room 130

SHAW ISLAND

Building 26, Room 101

SHELTON

Building 23, Room 220

SHORELINE

Building 26, Room 102

SKAMANIA

Building 21, Room 286

SKYKOMISH

Building 26, Room 102

SNOHOMISH

Building 26, Room 101

SNOQUALMIE VALLEY

Building 26, Room 102

SOAP LAKE

Building 23, Room 202

SOUTH BEND

Building 23, Room 220

SOUTH KITSAP

Building 21, Room 130

SOUTH WHIDBEY

Building 26, Room 101

SOUTHSIDE

Building 23, Room 220

SPOKANE

Building 21, Room 287

SPRAGUE

Building 23, Room 203

ST. JOHN

Building 23, Room 203

STANWOOD-CAMANO

Building 26, Room 101

STAR

Building 21, Room 106

STARBUCK

Building 21, Room 106

STEHEKIN

Building 23, Room 202

STEILACOOM

Building 23, Room 219

STEPTOE

Building 23, Room 203

STEVENSON-CARSON

Building 21, Room 286

SULTAN

Building 26, Room 101

SUMMIT VALLEY

Building 21, Room 287

SUMNER

Building 23, Room 219

SUNNYSIDE

Building 21, Room 285

TACOMA

Building 23, Room 219

TAHOLAH

Building 23, Room 220

TAHOMA

Building 26, Room 102

TEKOA

Building 23, Room 203

TENINO

Building 23, Room 220

THORP

Building 21, Room 285

TOLEDO

Building 23, Room 220

TONASKET

Building 23, Room 202

TOPPENISH

Building 21, Room 285

TOUCHET

Building 21, Room 106

TOUTLE LAKE

Building 21, Room 286

TROUT LAKE

Building 21, Room 286

TUKWILA

Building 26, Room 102

TUMWATER

Building 23, Room 220

UNION GAP

Building 21, Room 285

UNIVERSITY PLACE

Building 23, Room 219

VALLEY

Building 21, Room 287

VANCOUVER

Building 21, Room 286

VASHON ISLAND

Building 26, Room 102

WAHKIAKUM

Building 21, Room 286

WAHLUKE

Building 21, Room 285

WAITSBURG

Building 21, Room 106

WALLA WALLA

Building 21, Room 106

WAPATO

Building 21, Room 285

WARDEN

Building 23, Room 202

WASHOUGAL

Building 21, Room 286

WASHTUCNA

Building 23, Room 203

WATERVILLE

Building 23, Room 202

WELLPINIT

Building 21, Room 287

WENATCHEE

Building 23, Room 202

WEST VALLEY (SPOKANE)

Building 21, Room 287

WEST VALLEY (YAKIMA)

Building 21, Room 285

WHITE PASS

Building 23, Room 220

WHITE RIVER

Building 23, Room 219

WHITE SALMON

Building 21, Room 286

WILBUR

Building 23, Room 203

WILLAPA VALLEY

Building 23, Room 220

WILSON CREEK

Building 23, Room 202

WINLOCK

Building 23, Room 220

WISHKAH VALLEY

Building 23, Room 220

WISHRAM

Building 21, Room 286

WOODLAND

Building 21, Room 286

YAKIMA

Building 21, Room 285

YELM

Building 23, Room 220

ZILLAH

Building 21, Room 285

Legislative Committee Members

WSSDA

WSSDA CHAIR

Geoffery McAnallo, Federal Way

WSSDA DA 1

Tony Ghazel, Orcas Island
Nancy Truitt Pierce, Monroe

WSSDA DA 2

Danny Edwards, Riverview
Geoffery McAnallo, Federal Way
Sandy Hayes, Northshore
Angelica Alvarez, Highline

WSSDA DA 3

John Paul Wagemann, Clover Pk.
Debbie Winskill, Tacoma

WSSDA DA 4

John Campbell, North Mason
Carolynn Perkins, Bremerton

WSSDA DA 5

Neal Kirby, Centralia
Kim Reykdal, Tumwater

WSSDA DA 6

Mavis Nickels, Battle Ground
Jaron Barney, Washougal

WSSDA DA 7

Carrie Sorensen, Cascade
Joette Barry, Grand Coulee Dam

WSSDA DA 8

Michelle Perry, Sunnyside
Martha Rice, Yakima

WSSDA DA 9

Cindy McMullen, Central Valley
Dan Hansen, West Valley

WSSDA DA 10

Scott Carruth, Ritzville
John Zingg, Freeman

WSSDA DA 11

Brian Brooks, Kennewick
Steve Christensen, Pasco

WASA

WASA CHAIR

Mike Brophy, West Valley
(Yakima)

REGION 101

Brian Talbott, Nine Mile Falls

REGION 105

Mike Brophy,
West Valley (Yakima)
Becky Imler, Wapato

REGION 108

David Forsythe, NWESD 189

REGION 109

Marci Larsen, Mukilteo

REGION 110

Duggan Harman, Highline

REGION 111

Tom Seigel, Bethel

WASA REGION 112

Sandra Yager, Hockinson
Nathan McCann, Ridgefield

WASA REGION 113

Lisa Grant, Mossyrock

WASA REGION 114

Patty Page, North Kitsap

WASA REGION 123

Dave Bond, Kennewick

WASA REGION 171

Garn Christensen, Eastmont

WASBO

WASBO CHAIR

Corine Pennington, Puyallup

THE WASBO LEGISLATIVE

AFFAIRS COMMITTEE consists of school district business officials from over 100 districts across the state. The Committee is actively engaged in the fiscal impacts of implementing current legislation and informing future proposals. For 2017, the Committee's Chair and Vice Chair are Corine Pennington (Puyallup School District) and Linda McDermott (Spokane Public Schools).

“It is critical for policymakers to have the most timely and accurate information about the implications of their proposals on school districts and students. We should be the ones they turn to.”

-Corine Pennington
Puyallup School District Chief
Financial Officer, WASBO
Legislative Affairs Committee



Transportation & Parking

Hotel RL Shuttle

The Hotel RL (Red Lion) offers guests a 10-seat van that travels within a four mile radius. **Sunday**, the shuttle is available for transport to/from the SPSCC. **Monday**, the hotel shuttle runs to the Capitol every hour. Make required reservations at the front desk for each day.

Dash Shuttle

Olympia Intercity Transit Dash shuttle serves downtown Olympia, operating every 12 min. from 9:00 a.m. to 5:00 p.m., every 15 min. from 7:00 to 9:00 a.m. and 5:00 to 6:00 p.m.

Downtown Olympia Parking

Hourly parking (\$1.50/hour) available at the locations below and at meters throughout downtown Olympia and vicinity. Have change available, although some meters take credit/debit cards. Pay at the meter located at each lot:

Farmer's Market: North end of Capitol Way. Park in the green-striped stalls.

Visitor Parking at Maple Park: Maple Park Avenue & Jefferson Street. From I-5, take a left at the Jefferson roundabout and then a right onto Maple Park Avenue. The lot is immediately on your right.

Professional Arts Lot: 11th Avenue & Washington Street.

Note: All day parking is available at the Governor Hotel for \$5.00 a day. Park there and take the DASH up the hill to the Capitol.

Parking at the Capitol: Parking is limited at the Capitol. Lots near the Legislative buildings require payment (\$1.50/hour). Street parking on the N. Diagonal and S. Diagonal is convenient for early-arrivers. See map page 26.



DASH Shuttle: Legislative Session January 11 – March 10, 2017

LEGEND

- Weekday Route
- Saturday Route
- Shuttle Stop
- Point of Interest
- P Public Parking

Parking is limited on the Capitol Campus and downtown. So hop the free, fun Dash shuttle and leave the driving to us.

Visitor Parking - Maple Park
Open all year, \$1.50/hour

Intercity Transit complies with all federal requirements under Title VI which prohibits discrimination on the basis of race, color, or national origin. For more information contact Customer Service.

7:10AM – 8:55AM

LEAVES FARMERS MARKET	CAPITOL WAY & LEGION	INSURANCE BUILDING	MAPLE PARK & FRANKLIN ST.	NEWHOUSE BUILDING	SYLVESTER PARK	ARRIVES FARMERS MARKET
7:10am	7:13	7:17	7:21	7:26	7:29	7:35
7:25	7:28	7:32	7:36	7:41	7:44	7:50
7:40	7:43	7:47	7:51	7:56	7:59	8:05
7:55	7:58	8:02	8:06	8:11	8:14	8:20
8:10	8:13	8:17	8:21	8:26	8:29	8:35
8:25	8:28	8:32	8:36	8:41	8:44	8:50
8:40	8:43	8:47	8:51	8:56	8:59	9:05
8:55	8:58	9:02	9:06	9:11	9:14	9:20am

5:10PM – 5:55PM

LEAVES FARMERS MARKET	CAPITOL WAY & LEGION	INSURANCE BUILDING	MAPLE PARK & FRANKLIN ST.	NEWHOUSE BUILDING	SYLVESTER PARK	ARRIVES FARMERS MARKET
5:10pm	5:13	5:17	5:21	5:26	5:29	5:35
5:25	5:28	5:32	5:36	5:41	5:44	5:50
5:40	5:43	5:47	5:51	5:56	5:59	6:05
5:55	5:58	6:02	6:06	6:11	6:14	6:20pm

DASH OPERATES WEEKDAYS

Every 15 minutes: 7:10 – 8:55 a.m.
 Every 12 minutes: 9:06 a.m. – 4:54 p.m.
 Every 15 minutes: 5:10 – 5:55 p.m.

Hotel RL

LOWER LEVEL MEETING SPACE

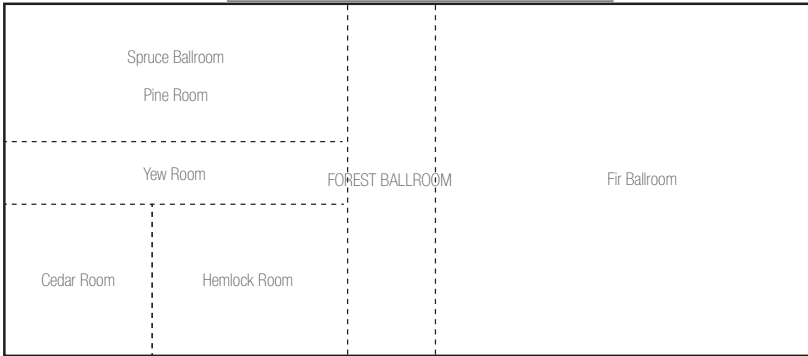

----- = Air Walls

LOBBY LEVEL

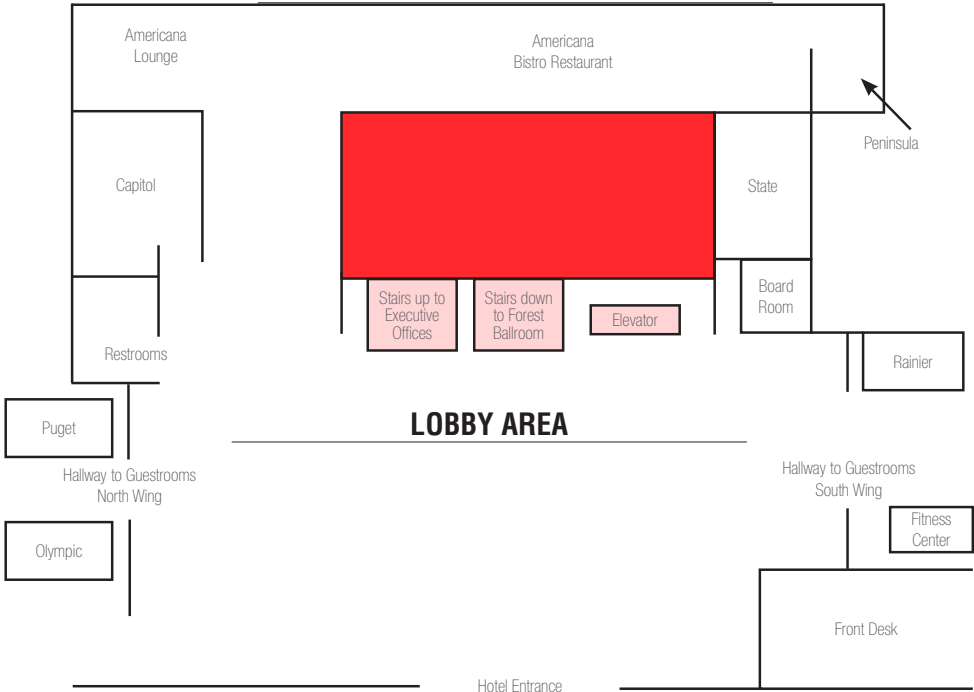

LOBBY AREA

South Puget Sound Community College

SYMBOLS

-  BICYCLE PARKING
-  DISABLED PARKING
-  COVERED WALKWAY
-  PEDESTRIAN WALKWAY
-  EMERGENCY PHONE
-  BUS STOP

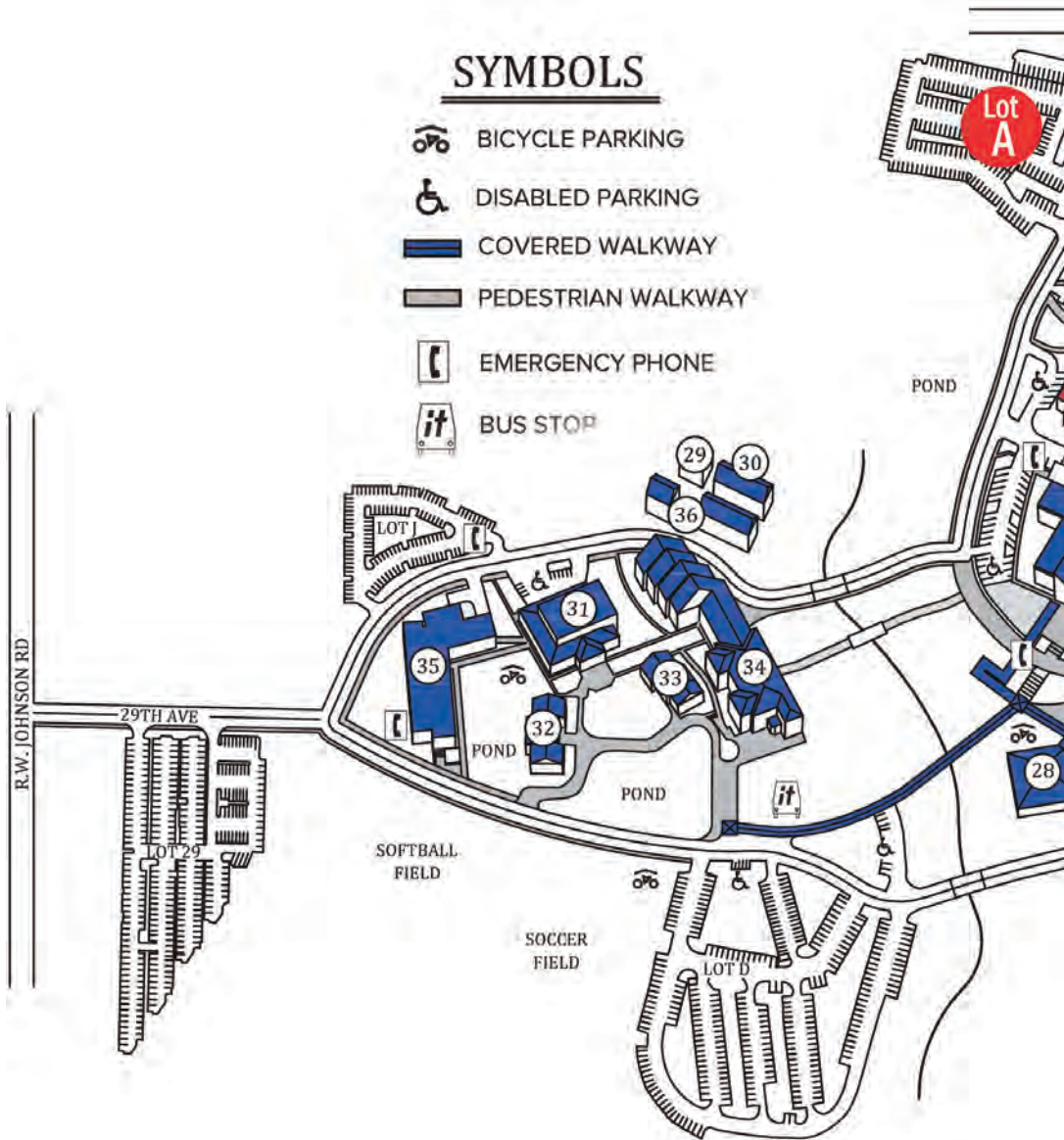

Building 21 – Center for the Arts

Building 23 – Applied Technology/Social Services

Building 27 – Student Union

Building 26 – Lecture Hall

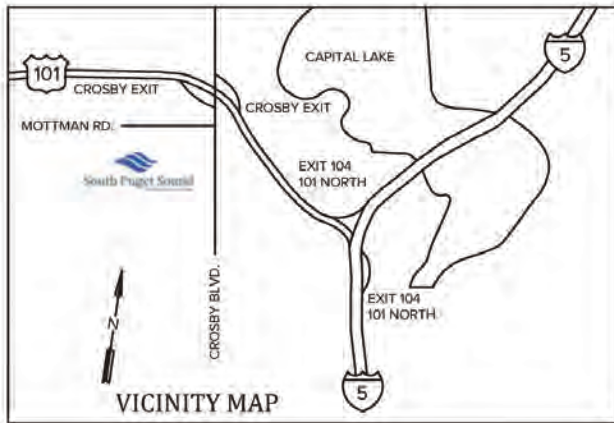
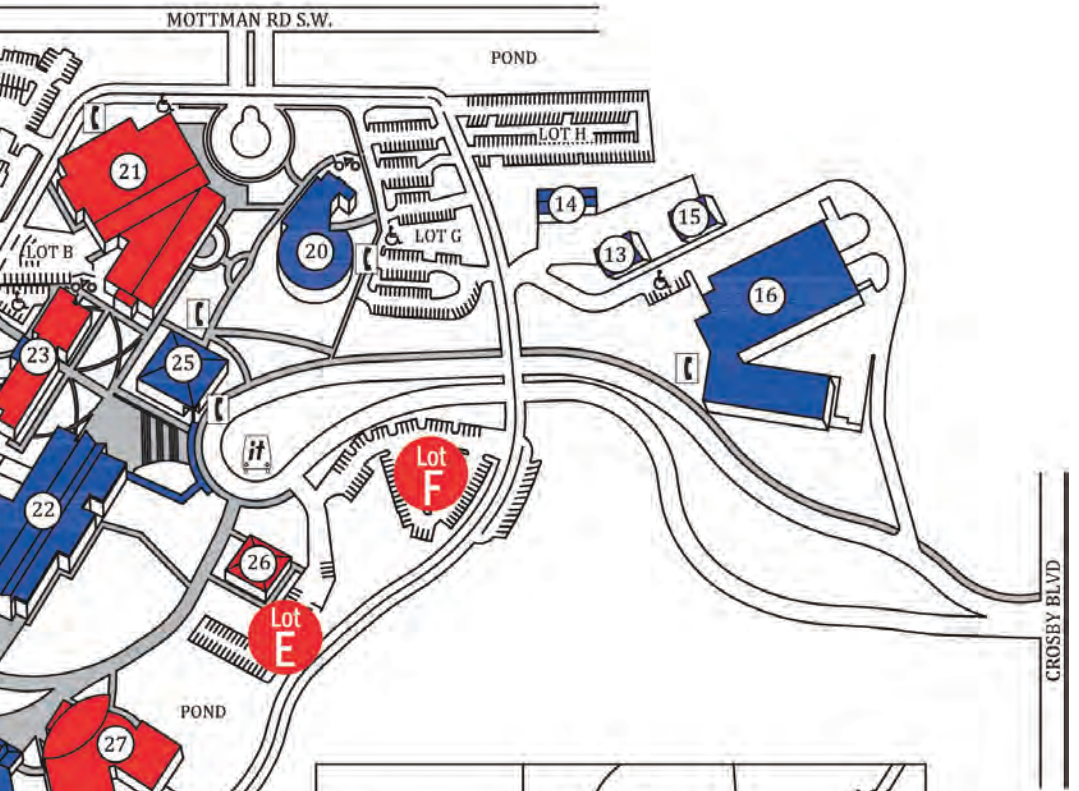

Building 21

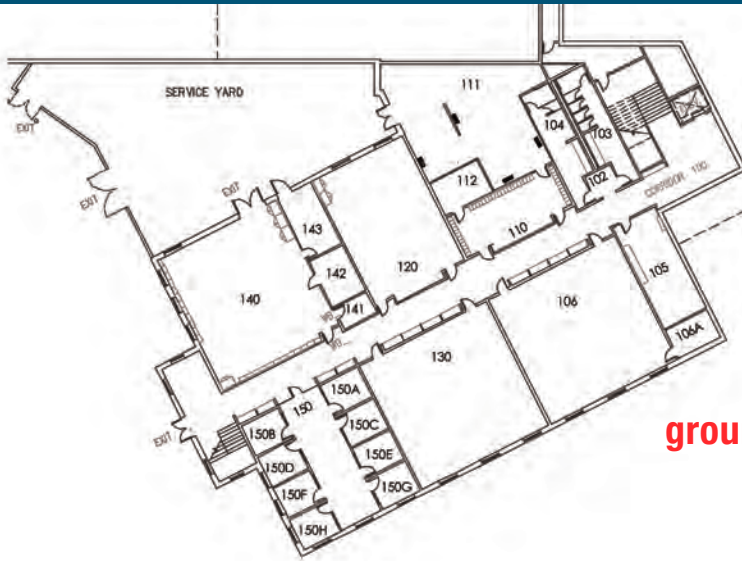

ground level



upper level

Building 23

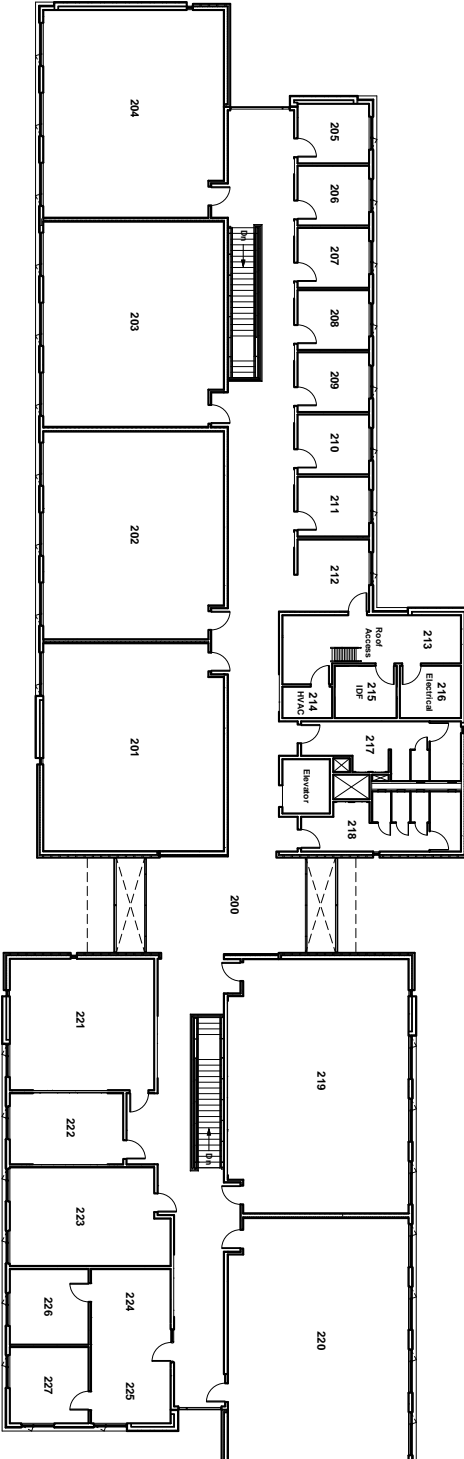



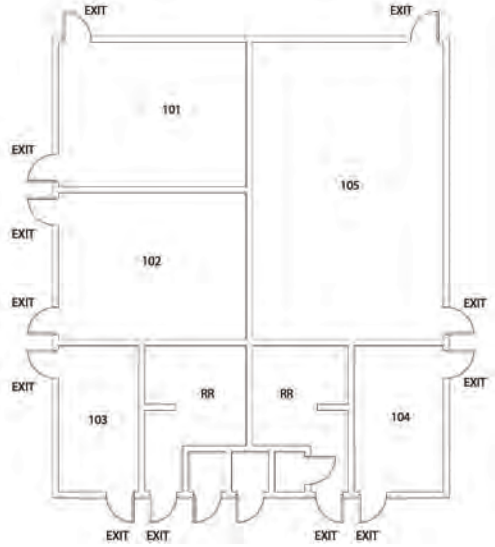









Building 26



Capitol Campus



Washington State Capitol Campus

-  Government building
-  Intercity Transit
-  Free shuttle
-  Bike rack
-  Guard Stations
-  Construction Project
-  Visitor Parking - \$1.50 per hour (requires exact change)
-  Entrance
-  Parking
-  Point of interest
-  School Bus Parking
-  Electric Vehicle Parking

Nov. 2016

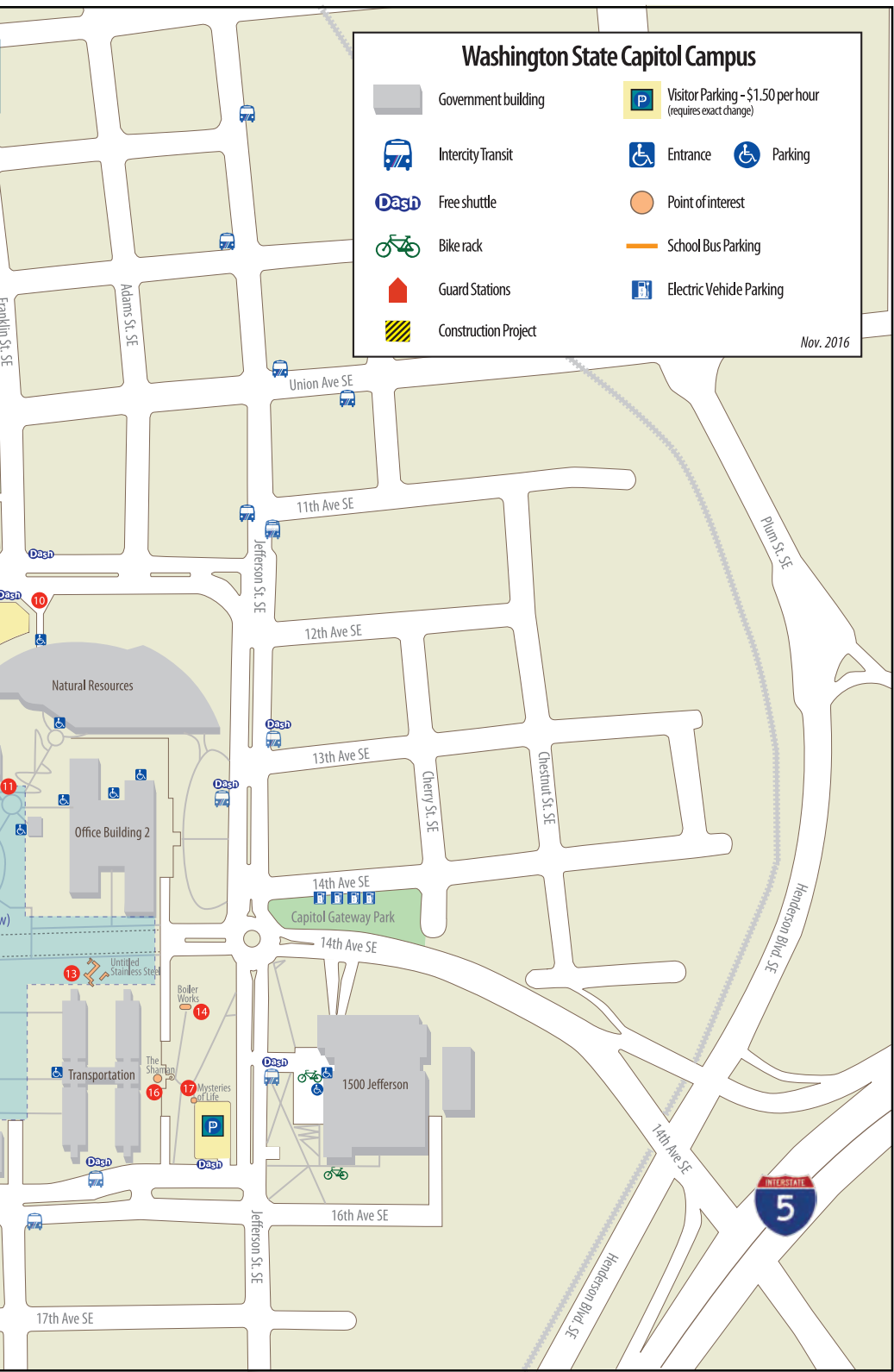



2017 Upcoming Events

March – May

WSSDA Spring Regional Meetings
Locations throughout Washington

March 13 – 14

WASA Small Schools Conference
Wenatchee

April 29

WASA Women in Leadership
Conference
Chelan

April 30 – May 2

WASA Superintendent Workshop
Chelan

May 4

WSSDA/PSESD Equity Convening
Seattle

May 10 – 12

WASBO Annual Conference
Spokane

May 24

WASA/WSSDA/AWSP Equity
Conference
SeaTac

June 25 – 27

WASA/AWSP Summer Conference
Spokane

July 24 – 25

WASA New Superintendent
Workshop
Olympia

July 24 – 27

WASBO Business Managers'
Conference
Vancouver

July 31 – August 2

WASA/OSPI Special Education
Workshop
Tacoma

September – October

WSSDA Fall Regional Meetings
Locations throughout Washington

September 22 – 23

WSSDA Legislative Assembly
Seattle

September 27

WASA Superintendent and CFO
Workshop
SeaTac

October 10

WASA Fall Conference
SeaTac

November 16 – 19

WSSDA Annual Conference
Bellevue

January 28 – 29, 2018

2018 Legislative Conference
Olympia